

# PERIMETER

**SURVEYING & MAPPING**  
 Certificate of Authorization No. LB7264  
 Prepared by: Jeff S. Hodapp, P.S.M.  
 951 Broken Sound Parkway, Suite 320  
 Boca Raton, Florida 33487  
 Tel: (561) 241-9988  
 Fax: (561) 241-5182

FOUND P.B.C.B.D.  
 IN CONC. MON.  
 E. 1/4 CORNER  
 SECTION 14-45-41  
 N 806291.115  
 E 910639.065

# YEE PLAT

PETITION NO. 2003-035 (COUNTRYSIDE MEADOWS AGR-PDD)  
 A PORTION OF THE SOUTH ONE-HALF OF SECTION 13, TOWNSHIP 45  
 SOUTH, RANGE 41, EAST, PALM BEACH COUNTY, FLORIDA.  
 OCTOBER, 2004

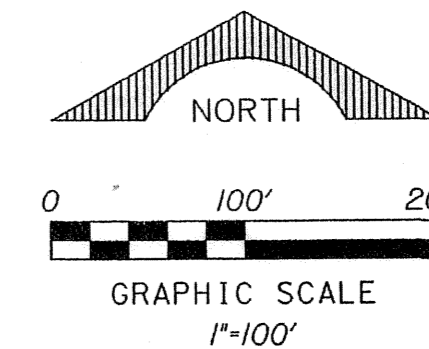

# 50

## SHEET 2 OF 3

"PLAT NO. 1 WILLIS GLIDERPORT"  
 (P.B. 32, PGS. 146-148)

N 80556.37' (M)  
 998.99' (M)  
 998.15' (P)  
 S 500°56'37" W  
 W. LINE SECTION 13-45-41  
 986.15' (D) 985.92' (M)  
 S 500°56'37" E  
 1657.61' (D) 1656.92' (M)

**P.O.C.**  
 FOUND 4"X4" CONC.  
 MON. (NO ID)  
 S.W. CORNER  
 "PLAT NO. 1 WILLIS  
 GLIDERPORT"

N89°25'49"E 2436.70' (D)  
 N88°59'12"E 2436.73' (C)

### LEGEND:

- ⊙ SET P.R.M. (UNLESS OTHER- WISE NOTED)-4" X4" CONC. MON. WITH ALUMINUM DISK STAMPED P.R.M. #LB7264
- ⊙ P.C.P. CENTERLINE

### ABBREVIATIONS:

- CONC. CONCRETE
- COR. CORNER
- D. DELTA (CENTRAL ANGLE)
- D.E. DRAINAGE EASEMENT
- L. ARCLength
- L.A.E. LIMITED ACCESS EASEMENT
- L.B. LICENSED BUSINESS
- L.E. LANDSCAPE EASEMENT
- L.S. LICENSED SURVEYOR
- L.W.D.D. LAKE WORTH DRAINAGE DISTRICT
- MON. MONUMENT
- O.R.B. OFFICIAL RECORDS BOOK
- N.R. NON-RADIAL
- P.B. PLAT BOOK
- P.B.C.R. PALM BEACH COUNTY RECORDS
- P.C. PAGE
- P.C.P. PERMANENT CONTROL POINT
- P.O.B. POINT OF BEGINNING
- P.O.C. POINT OF COMMENCEMENT
- P.R.M. PERMANENT REFERENCE MONUMENT
- P.S.M. PROFESSIONAL SURVEYOR & MAPPER
- P.U.D. PLANNED UNIT DEVELOPMENT
- R. RADIUS
- R/W. RIGHT-OF-WAY
- SEC. SECTION
- S.F. SQUARE FEET
- U.E. UTILITY EASEMENT

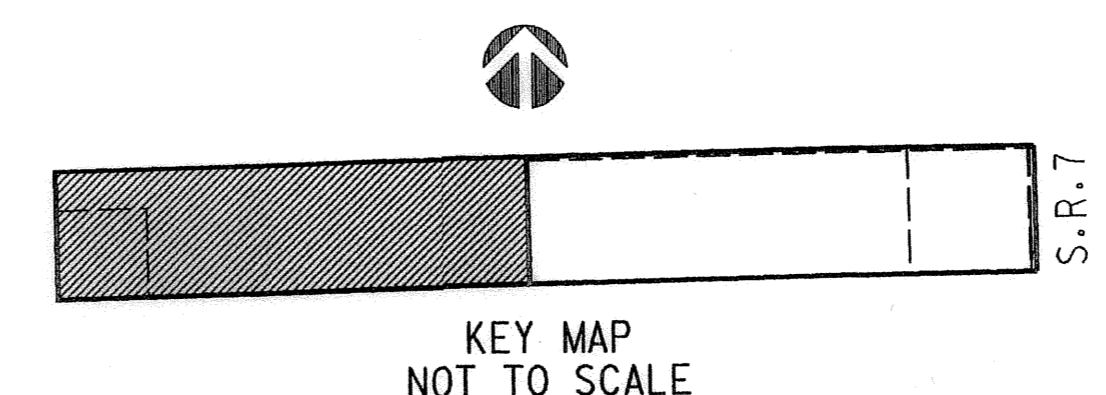

NOT INCLUDED

UNPLATTED SECTION 13-45-41

N88°59'12"E 2436.47'  
 S00°55'43"E 0.91'  
 N88°58'56"E 2619.84'

DETAIL N.T.S.

**P.O.B.**  
 N 804306.425  
 E 910671.757

N 804306.514  
 E 910676.757  
 SET OFFSET P.R.M.  
 5.00' E. ON LINE

N88°59'12"E 2436.47'  
 North line O.R. Book 5753, Page 129  
 1218.24' PRM TO PRM

N 804327.972  
 E 911889.821

N 804349.519  
 E 913107.884

N 804348.608  
 E 913107.899

**TRACT A**  
 3,379,691 SF  
 77.587 ACRES

SUBJECT TO CONSERVATION EASEMENT  
 IN FAVOR OF PALM BEACH COUNTY  
 (O.R.B. 18012, PG. 348)  
 2726277 SF  
 62.587 ACRES

AREA NOT SUBJECT TO  
 CONSERVATION EASEMENT  
 217800 SF  
 5.000 ACRES

UNPLATTED SECTION 14-45-41

N 800566.37' W  
 671.00'  
 671.46' (D)

FOUND 1 1/4" I.P.  
 DISTURBED  
 S.E. CORNER  
 SECTION 14-45-41  
 (0.15' N, 0.15' E)  
 FOUND P.B.C.B.D.  
 IN CONC. MON. ON SIDE  
 N 803635.506  
 E 910682.809

N 803635.877  
 E 910702.806  
 SET OFFSET P.R.M.  
 20.00' E. ON LINE

N 803660.008  
 E 912004.472

FOUND 4"X4" PRM  
 "ROBERT E. OWENS"  
 LB4 (1.20' S.)

BLOCK 52  
 "PALM BEACH FARMS COMPANY PLAT NO.3"  
 (P.B.2, PGS. 45-54, P.B.C.R.)

SUBDIVISION YEE PLAT  
 BOOK 104  
 FLOOD ZONE B  
 QUAD # 64  
 SE  
 TAZ 7142  
 PUB NAME  
 PAGE 50  
 FLOOD MAP # 100 B  
 ZONING AGR  
 ZIP CODE 33497

SEE SHEET 3